

PCM-3A

Input-output Module

Description

PCM-3A provides the fire alarm control panel control on/off signal to the field devices with the line supervisory. Using SLC communication, electronic address programming, need external 24VDC power supply.

Mix addressing of detectors and modules on same SLC, which makes on-site wiring, installation and programming more convenient.

Features

- Improved design for ease of wiring meaning faster installation.
- Address range 1 – 254¹⁾.
- Configurable modes¹⁾.
- Input active LED.
- Output active LED.
- Polling LED.
- Soft Addressing: the device address can be set by a programmer.

NOTE: 1) Core Lite enabled systems feature, please check with your system partner for availability.

Specifications

Supply Voltage (Vmin-Vmax): 17V – 28V DC.

Communication Protocol Voltage: 5V – 9V peak to peak.

Rated Voltage: 24V DC.

Quiescent Current: 2mA (Rated voltage 24V DC).

Maximum Current: 5mA (Rated voltage 24V DC).

Maximum Output Current: 1A @30V DC.

Operating Temperature: -10°C ~ 55°C.

Humidity: 0% - 95%RH (non-condensing).

Dimension: 88mm length × 34mm width × 102mm height.

Weight: 80g.

Standard: GB16806-2006 & EN54-18:2005/AC:2007.

Approvals: CCCF & UL.

UL-EU-Mark.



Terminal

The terminal L-, L+ is for connecting the loop wire.

The terminal IP+, IP- is for connecting the input wire.

Terminal OP+, OP- is for connecting the output wire.

Terminal 24+, 24- is for connecting the external 24V DC power supply.

- L- is "Loop -"
- L+ is "Loop +"
- IP+ is for connecting the "Input +"
- IP- is for connecting the "Input -"
- OP+ is for connecting the "Output +"
- OP- is for connecting the "Output -"
- 24+ is for connecting the "Power +"
- 24- is for connecting the "Power -"

Dimensional Drawing

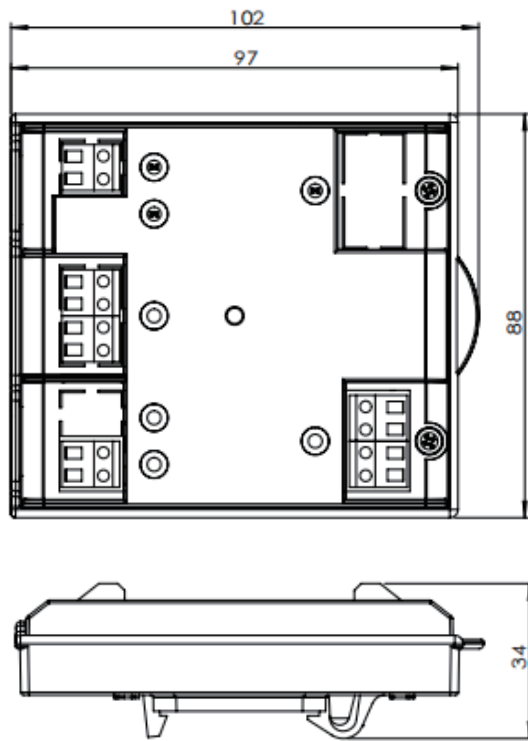

Status Indications

Legend	LED Status	Description
Output Active	Continuous Red	Output active LED
Input Active	Continuous Red	Input active LED
Polling	Flashing Red	Polling LED

Electrical Consideration

The quiescent current of Input/Output Module is 2mA at rated voltage of 24V DC.

Mechanical Construction

The main components of the Input/Output Module are molded in a robust fire-retardant polycarbonate and PC/ABS.

The Input/Output Module is designed to be mounted on a 35mm width DIN-Rail inside an enclosure.

NOTE: This unit is not designed for outdoor use.

Operating Modes-Input Modes

Mode	Description
1	Input circuit fault is reported when the input line is short circuit (Default)
2	The input activation is reported when the input line is short circuit

Operating Modes-Input Delay Modes

Mode	Description
1	0S delay after input activation (Default)
2	10S delay after input activation
3	20S delay after input activation
4	30S delay after input activation

Operating Modes-Output Operating Modes

Mode	Description
1	Continuous output after output activation (Default)
2	Pulse output after output activation (1S Open 1S Close)
3	Pulse output after output activation (3S Open 1S Close)
4	Pulse output after output activation (6S Open 1S Close)